

MATERIAL

Housing : Polyamide (GFR 30%) , black
T-Handle : Zinc die, black painted or
chrome plated
Cam : Steel, zinc plated

CUTOUT

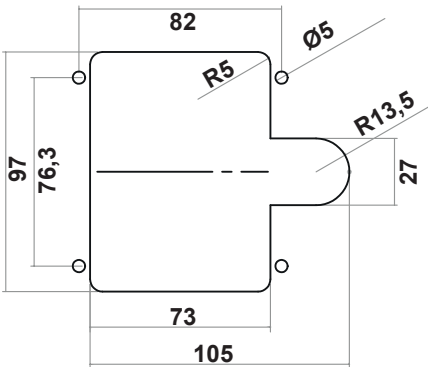

7634 - Cabinet Lock with T-Handle and Fixed Cam
Grip range (H) : 60mm



Keyed Same	T-Handle : Zinc die, black painted	T-Handle : Zinc die, chrome plated
With Screws M5	7634 - 123 - 460	7634 - 123 - 460 - K
With countersunk hole of M5	7634 - 023 - 460	7634 - 023 - 460 - K

Please contact Elkomsan for different grip measurements